



📍 Flat 1, Bailey House Forman Street, Calne, Wiltshire, SN11 8PG

🔗 Auction Guide £65,000

- For Sale by Online Auction
- Thursday 12th February 2026
- Lot 13
- Guide Price £65,000+

🏠 Leasehold

🏠 EPC Rating C



LOT 13
FOR SALE BY ONLINE AUCTION
THURSDAY 12th FEBRUARY 2026
GUIDE PRICE £65,000+

2 Bedroom lower ground floor flat in need of modernisation.

Calne provides a good range of shopping, schooling and leisure amenities. The nearby town of Chippenham has a mainline railway station and access to the M4 motorway.

The accommodation comprises communal entrance hall with staircase down to the flat. Entrance hall, lounge, kitchen, 2 bedrooms and bathroom. It measures about 63m² and has double glazing and electric heating.

There is an enclosed garden area off the lounge which overlooks the communal grounds. There is no allocated parking but on street parking is available in the vicinity.

The flat is leasehold with a new 125 year lease. Further details and costs will be in the legal pack.

Situation and Description

2 Bedroom lower ground floor flat in need of modernisation.

Calne provides a good range of shopping, schooling and leisure amenities. The nearby town of Chippenham has a mainline railway station and access to the M4 motorway.

The accommodation comprises communal entrance hall with staircase down to the flat. Entrance hall, lounge, kitchen, 2 bedrooms and bathroom. It measures about 63m² and has double glazing and electric heating.

There is an enclosed garden area off the lounge which overlooks the communal grounds. There is no allocated parking but on street parking is available in the vicinity.

The flat is leasehold with a new 125 year lease. Further details and costs will be in the legal pack.

What3Words///respects.inflation.groom

Viewings

To arrange a viewing, contact: Chippenham office on 01249 652717

There will be numerous pre-arranged open house viewing slots lasting for 30 minutes and you can book in by contacting the Auctioneers.

If you have any concerns with viewings, please contact the relevant Strakers office and we would be happy to discuss them with you and hopefully put you at ease.



Floor Plan

Approx. 59.5 sq. metres (640.8 sq. feet)

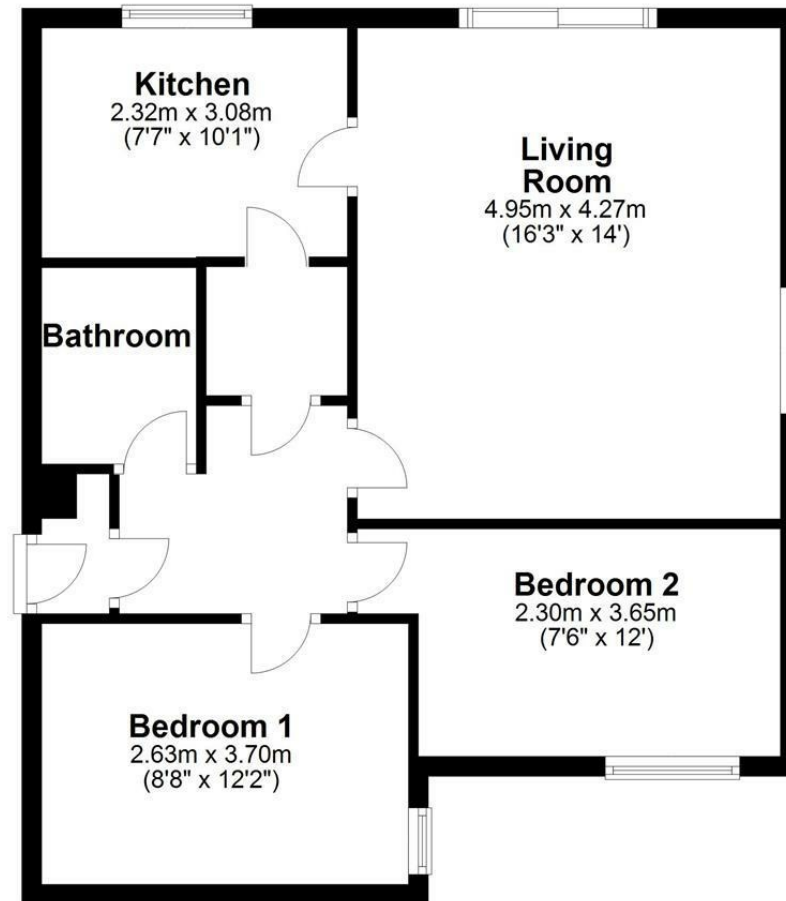

Total area: approx. 59.5 sq. metres (640.8 sq. feet)

Illustration for identification purposes only, measurements are approximate, not to scale.
Plan produced using PlanUp.

Disclaimer: These particulars, whilst believed to be accurate are set out as a general outline only for guidance and do not constitute any part of an offer or contract. Intending purchasers should not rely on them as statements of representation of fact, but must satisfy themselves by inspection or otherwise as to their accuracy. No person in this firm's employment has the authority to make or give any representation or warranty in respect of the property. All measurements and distances are approximate only. Your home is at risk if you do not keep up repayments on a mortgage or other loan secured on it.